

# MOLE PER RIBASSI

## STUBBING WHEELS

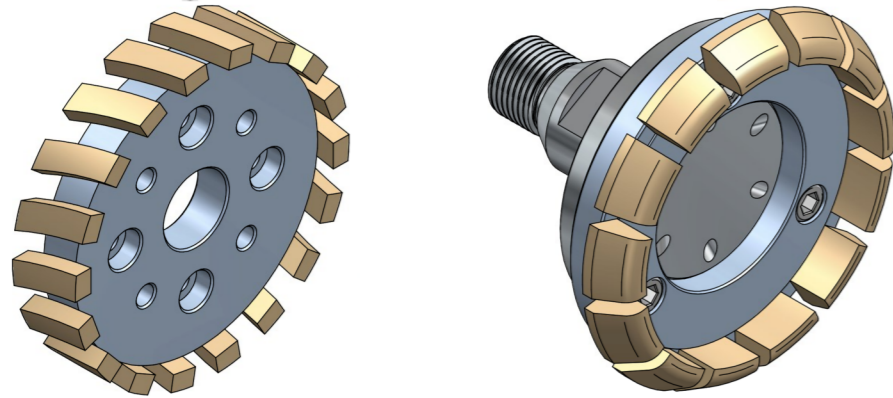

Utensile indicato per il ribasso e/o rimozione del bordo di lastre in granito.

- Tipologia per macchina CNC
- Uso ad umido

Per macchina CNC/for CNC machine

Tool suitable for stubbing and/or edge removing on granite slabs.

- Types for CNC machines
- Wet use

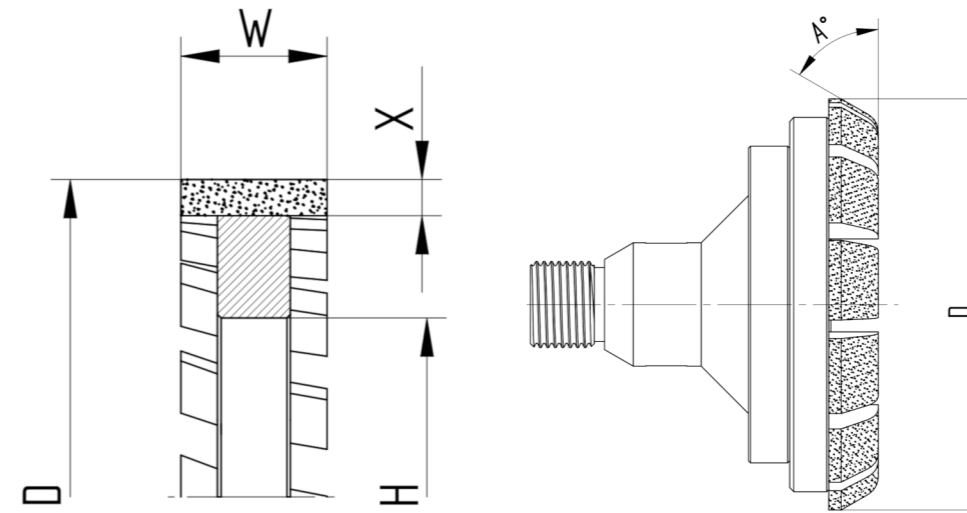
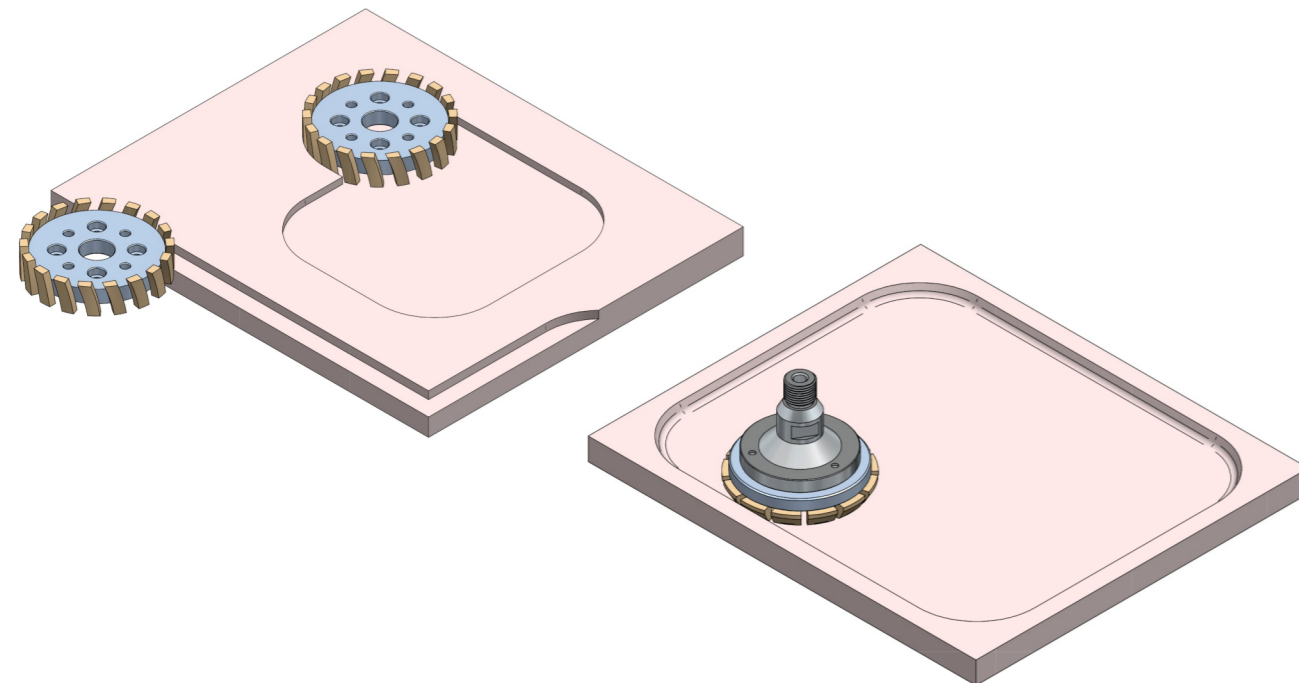

### MISURE STANDARD

### STANDARD SIZES

D = diametro/diameter  
X = altezza/height  
W = fascia/rim

### MOLE PER RIBASSI/STUBBING WHEELS

D	W	X	Uso per/Use for
50	20	5mm	Granito/Granite
86	20	5mm	
86	30	5mm	
100	20	5mm	

### MOLE PER RIBASSI 60°/60° STUBBING WHEELS

Ø	W	A°	Grana/Grit	Uso per/Use for
100	10x12	60°	grossa/coarse	Granito/Granite
100	10x12	60°	media/medium	
100	10x12	60°	Fine	